

Hairmyres Hospital (floor plans)

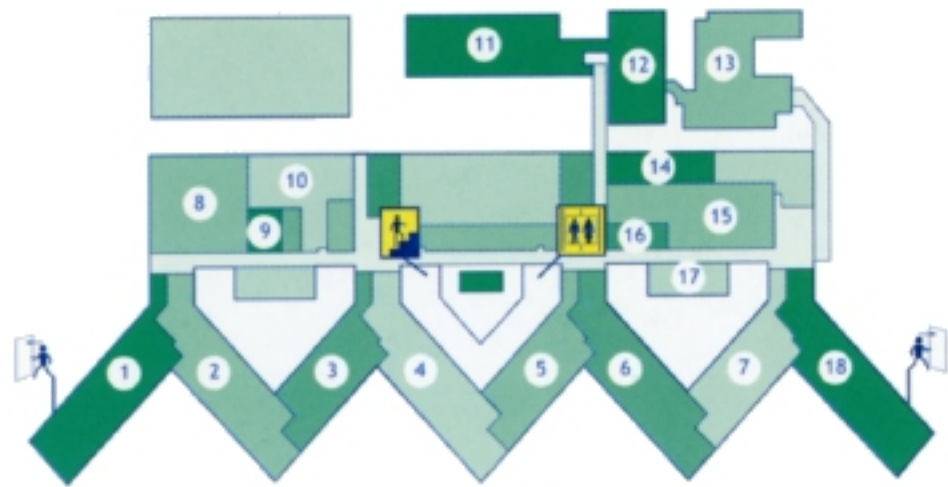

Second floor

- | | |
|---------------------------------------|--|
| 1 Management Offices East Wing | 11 Microbiology and Haematology Laboratories |
| 2 Ward 9 | 12 Biochemistry Laboratory |
| 3 Ward 10 | 13 Pathology/Mortuary |
| 4 Ward 11 | 14 Communications Room |
| 5 Ward 12 | 15 Pharmacy |
| 6 Ward 13 | 16 CSSD |
| 7 Ward 14 | 17 Oncology Day Centre |
| 8 Coronary Care Unit | 18 Management Offices West Wing |
| 9 Anaesthetic Office | |
| 10 Cardiac Catheterisation Department | |



Elevator (for public)



Stairs (for public)



Fire escapes

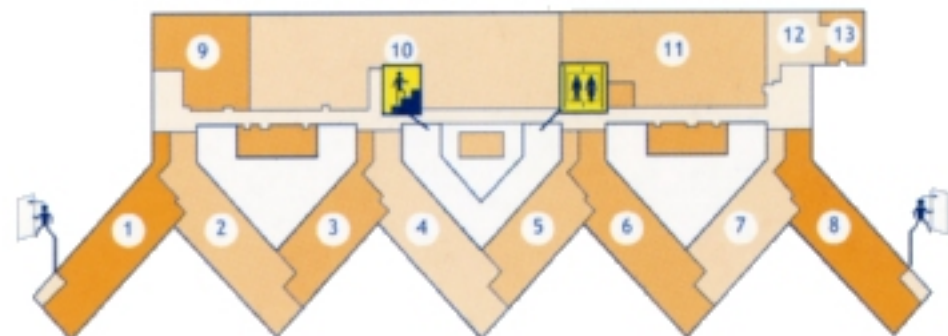

First floor

- | | |
|----------|----------------------------------|
| 1 Ward 1 | 8 Ward 8 |
| 2 Ward 2 | 9 ITU/HDU |
| 3 Ward 3 | 10 Operating Department |
| 4 Ward 4 | 11 Day Surgery |
| 5 Ward 5 | 12 Rapid Access Unit |
| 6 Ward 6 | 13 Maternity Day Assessment Unit |
| 7 Ward 7 | |



Elevator (for public)



Stairs (for public)



Fire escapes

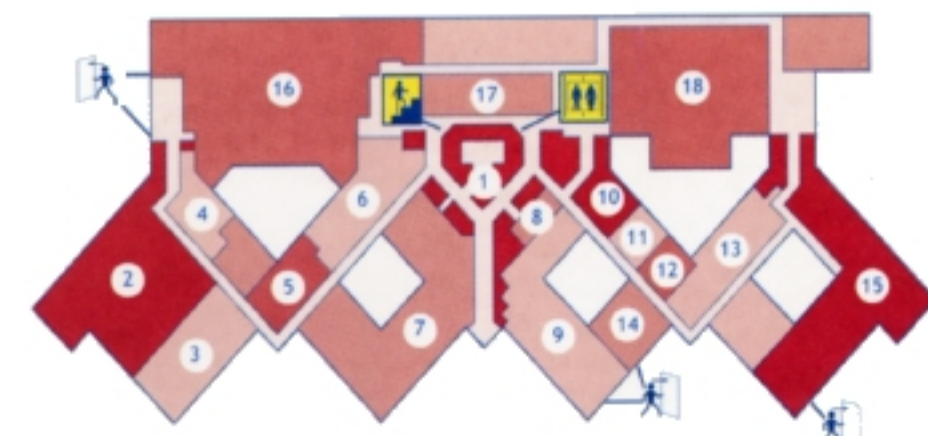

Ground floor

- | | |
|------------------------------------|--------------------------------------|
| 1 Atrium | 10 Diabetes Centre |
| 2 Accident and Emergency | 11 Social Work |
| 3 Medical Cardiology | 12 Salus Occupational Health Service |
| 3 Respiratory Medicine | 13 Education and Training Centre |
| 4 ENT, Audiology and Dental Clinic | 14 Preassessment Centre |
| 5 Ophthalmology | 15 Rehabilitation Services |
| 6 Orthopaedic Clinic | 16 X-Ray Department |
| 7 Outpatients Department | 17 Retail |
| 8 Medical Illustration | 18 Catering |
| 9 Medical Records | |



Elevator (for public)



Stairs (for public)



Fire escapes